

ASSEMBLY INSTRUCTION FOR ADDICARE UNIT

201684

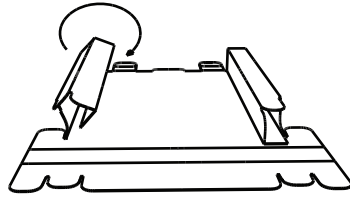

Step 1.
Take a shelf and roll the sides to form a box section.

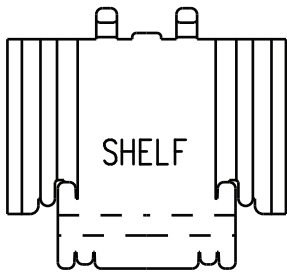
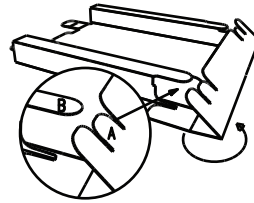

Step 2.
Fold the front around ensure 'A' sits under 'B' as shown in the detail image.

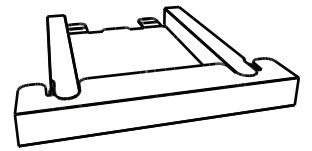

Step 3.
When completed the shelf will look as shown. Repeat for other shelf.

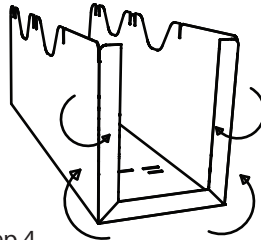
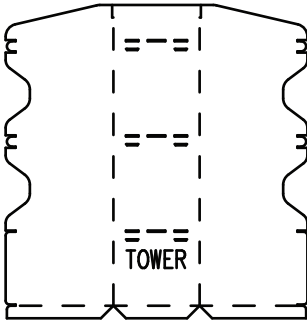

Step 4.
Fold up the tower as shown. Fold up the 2 sides and fold in the 3 base flaps, as shown.

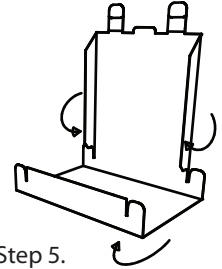
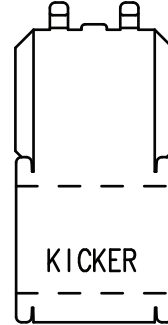

Step 5.
Fold the kicker panel as shown.

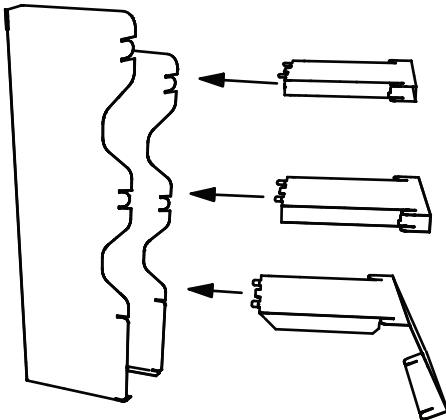

Step 6.
Slide the 2 shelves and the kicker into position in the tower, ensure the tabs on the rear of the shelves and kicker exit through the slots in the back of the tower. To lock fold the tabs back into the slots below their current position.

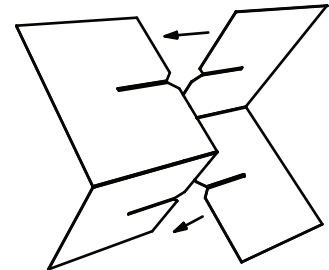
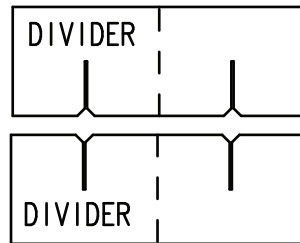

Step 7.
Take the 2 dividers and fold them to 90 degrees and slot them together as shown above.

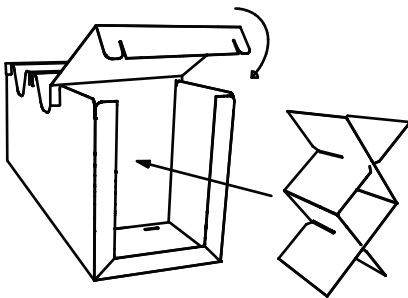

Step 8.
Once slotted together place the dividers into the base of the unit and lock in the kicker panel.

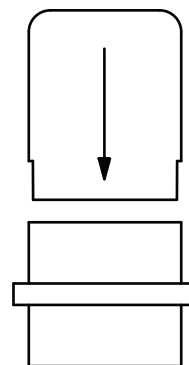

Step 9.
Slide the header card into the top of the unit ensure it sits in the slots provided in the back corners.

